



**Activity – Your local area 'then and now'**

Find your local area on the modern map. You can use the 'How to search for modern streets on the Booth Map' helpsheet to do this.

Look for a street, a road or a district.

The search engine will find the same area on the Booth's *Map Descriptive of London Poverty, 1898-9*. You can scroll down to see the modern day map

Compare the two maps.

Can you see any differences in the area? Are the major streets the same?

Can you see any institutions in your local area? Are they featured on both maps? Write your comments below.

How things have changed	How things have stayed the same



**Activity – What the Booth colours of the streets represent**

Study the Booth map. What colours appear on the map in your area and what do they stand for?.

Are the majority of streets black, light blue, dark blue, purple, pink, red or yellow?

The colours represent the degree of poverty or wealth in the street. Evaluate whether the community living in this area are rich, poor or average by comparing the colours to Booth's classification. This is shown on the right hand side of the maps

Do you think richer or poorer people are living in the area today compared to 1898?



**Walks around London**

The social investigators may have walked around your local area. All of their notebooks are on the web site. Use the 'How to search the original survey notebooks' helpsheet to find a report on your local area.

Remember to use the 1898 street and district names in your search.

**Descriptions of street**

Look at the entry for a street you know well. For example, the street where your school is situated. Summarise in your own words what it says.

**Using the evidence**

What problems did you have in reading and using this evidence?

**Evaluating the evidence**

What are your views on the social investigator's opinion of the street? Are the opinions justified? Could the social investigator's opinions be influenced by his own upbringing?



### Recording information

The social investigators sometimes sketched the façade of a typical house in the street.

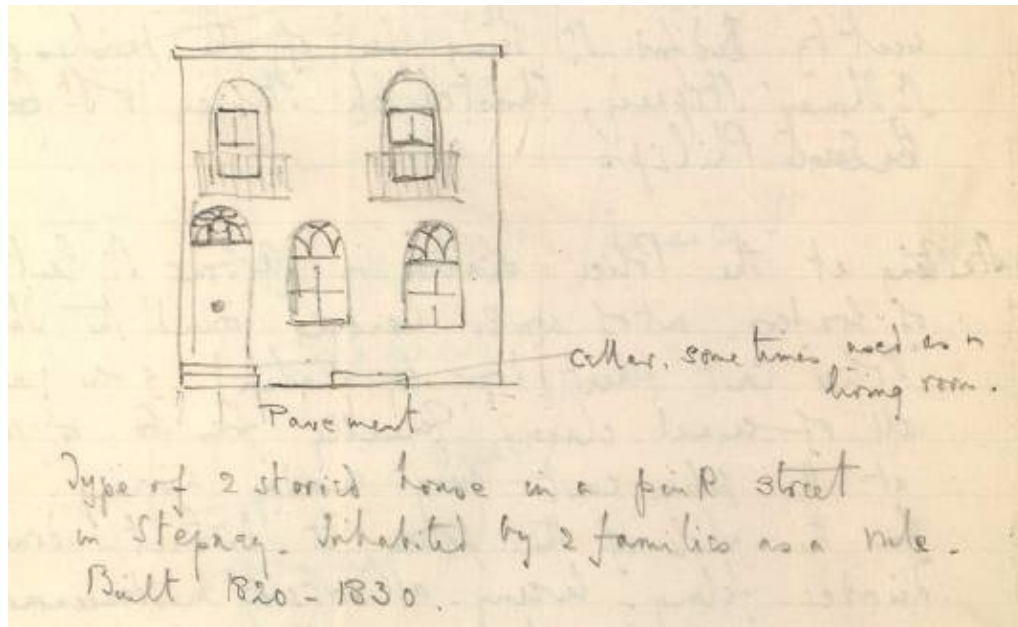

Booth B350 p.94

Sketch a typical house in your street.

Write a report, in the style of a social investigator, of the street where you live. You could write your report using the information reported by the social investigators from Charles Booth's survey. Or you could write a report about your modern day street.

Describe the appearance of the houses, roads, and inhabitants and indicate the level of poverty or wealth of the inhabitants. What are your impressions of the street? Record your observations

If your street is not covered by the survey, find a street you know well.



## How to search for modern streets on the Booth map

- Look for this section and click on **Search**
- Click on **Streets in 2000**
- Type in the name of the street or road you want
- Click on **Go**

If your search is successful then your screen will look like this:

If your search is unsuccessful then it will look like this:

Look for this section on the left of the screen and type your placename in again, then click on **Go**

- Click on **View on map** to see the 1898 map
- Scroll down to see the modern day map

- [Introduction and guides to the archives](#)
- Poverty maps of London: [Browse](#) or [Search](#)
- [Inquiry into life and labour in London](#)
  - [Search the catalogue of original survey notebooks](#)
  - [Browse the digitised police notebooks](#)
- [Booth family papers](#)
- [Contacts](#)
- [Streets in 2000](#)
- [Postcodes in 2000](#)
- [Wards in 2000](#)
- [Landmarks in 1898](#)
- [Parishes in 1898](#)

Street	Postcode
Sirdar Road <ul style="list-style-type: none"> <li>▶ <a href="#">View on map</a></li> <li>▶ <a href="#">Search for in catalogue</a></li> </ul>	<a href="#">W11</a>

Street	Postcode
Sorry, there are no streets with that name in the database of London streets in 2000 for the area of the Booth maps. Try deleting non-unique parts of the street name (eg. 'road', 'street') and choosing the 'Containing' option.	

Search for modern streets:

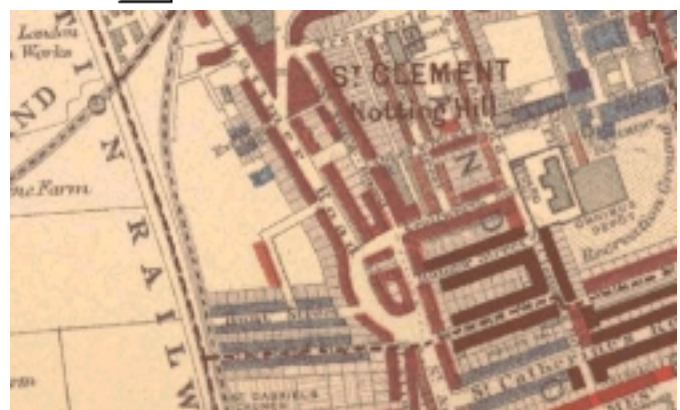



## How to search the original survey notebooks

- Look for this section and click on [Search the catalogue of original survey notebooks](#)
- Type in the street, road or place you want
- Click on 

If your search is successful then your screen will look something like this. You may have more entries depending on what you are looking for.

- [Introduction and guides to the archives](#)
- Poverty maps of London: [Browse](#) or [Search](#)
- [Inquiry into life and labour in London](#)
  - [Search the catalogue of original survey notebooks](#)
  - [Browse the digitised police notebooks](#)
- [Booth family papers](#)
- [Contacts](#)

Search survey notebook pages:

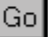

Notebook and Page	Entry in catalogue
Booth B359, p143	<p>Sirdar Road, Crescent Street.</p> <ul style="list-style-type: none"> <li>▶ <a href="#">Show other pages in this notebook</a></li> <li>▶ <a href="#">Display digitised image of this page</a></li> <li>▶ <a href="#">View approximate location on map</a></li> </ul>
Booth B359, p149	<p>Greenfell Road, Sirdar Road, St. Ann's Road, St. Ann's Villas, Abbey Road, St. James Terrace, St. James' Square.</p> <ul style="list-style-type: none"> <li>▶ <a href="#">Show other pages in this notebook</a></li> <li>▶ <a href="#">Display digitised image of this page</a></li> <li>▶ <a href="#">View approximate location on map</a></li> </ul>

If your search is unsuccessful then it will look like this:

Notebook and Page	Entry in catalogue
Sorry, there are no catalogue entries for pages in the survey notebooks that mention the keywords you have entered.	

- Click on [Display digitised image of this page](#)
- You will be asked to choose DjVu or JPEG format to view the notebooks. DjVu needs extra software which you will need to download. Click on JPEG unless you especially want to use DjVu.
- Use the scroll bar to move around the page

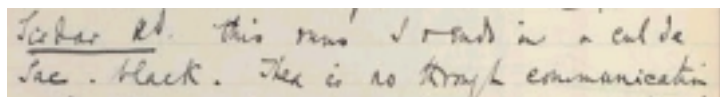

- Use these arrows  to move from page to page
- Click on the down arrow next to 'From this page you can ...' to get this list and make another search or go to another section

From this page you can... 

- From this page you can...
- View with DjVu plugin
- Find matching area on map
- Read catalogue entry for this page
- Go to a different page
- Go to the first page in this walk
- List walks and interviews in this notebook
- Return to the home page
- More options...